

GENERAL SPECIFICATIONS

• L.O.A:	14,78m	48'6"
• Hull length:	13,50m	44'3"
• Overall width:	4,20m	13'9"
• Beam:	4,15m	13'7"
• Light displacement (EC):	11 241kg	24,782 lbs
• Air draft*:	4,59m	15'
• Draught:	1,20m	3'9"
• Fuel capacity:	2 x 450L	2 x 119 US Gal
• Freshwater capacity:	2 x 200L	2 x 53 US Gal
• Maximum engine power:	2 x 328Kw - 2 x 440 HP	2 x 440 HP
• Max engine certification:	2 x 328Kw - 2 x 440 HP	2 x 440 HP

* (Included: Radar support)

ARCHITECTS / DESIGNERS

- Naval Architect: Beneteau Power Boats & MICAD
- Design: Andreani Design

EC CERTIFICATION

- Category B - 12 people
- Category C - 12 people

AIR STEP SYSTEM®

- R.L. Jeantet
- P. Tableau
- M. Tronquez

2-cabin layout

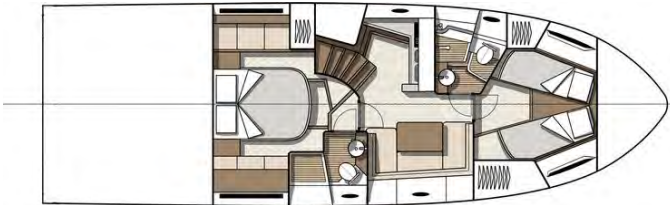

3-cabin layout

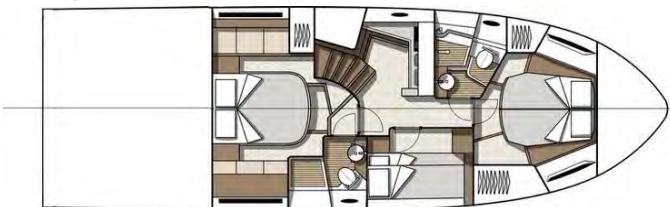

seanapps

CONNECT YOUR BOAT FREE YOUR MIND

STANDARD EQUIPMENT

CONSTRUCTION

HULL

- Air Step system®
- White hull
- Composition:
 - Sandwich (Polyester resin - Glass fiber - Balsa core)
 - Hull counter moulding laminated in monolithic (Polyester resin - Glass fiber)
- 8 opening portholes

DECK

- Composition:
 - Sandwich (Polyester resin - Glass fiber - Balsa core)
 - Deck counter moulding laminated in monolithic (Polyester resin - Glass fiber)

DECK EQUIPMENT

- Courtesy light in cockpit
- Navigation lights

MOORING LINES - MOORING

- Bow fitting with anchor securing system
- 1 000 W Electric windlass (with remote control)
- 2 Forward cleats, 2 central and 2 aft in stainless steel

SAFETY ON DECK

- Half open pulpit in stainless steel with guardrail and hand rail
- 2 Stainless steel handrails on access to side decks steps

COCKPIT

- Self-bailing cockpit
- Access through a gate with safety catch
- Cockpit windows
- 8 persons saloon
- Solid wood cockpit table
- 1 220 V socket
- 4 Storage lockers (under the seats)
- Cockpit galley with sink, foldaway tap, Stowage & Bin
- Engine access hatch
- Space for cased life-raft
- Cockpit shower with mixer tap
- Swim platform (3,62 x 1,33m / 11'11" x 4'4") + Swimming ladder
- Hand rail on aft transom
- Choice of exterior upholstery:
 - Marlin Auster (standard)
 - Dolce Vita (option)
- Sun bed
- Tender garage:
 - Tender (230 cm / 9')
 - Electrically-opened, using 2 electric struts
 - Access to engine room by the garage
- Aft galley featuring BBQ grill (Option)
- Space for pop-up 40" television (pre-installation optional)
- Cockpit windows with opening portholes to port and starboard

STEERING STATION

- Polyester, Steering station to starboard
- Pilot seat with function Bolster
- Double bench seat with Bolster option (Co-pilot)
- Foldable footrest
- Pilot and co-pilot upholstery matching the cockpit saloon
- 2 Handrails
- Grey Black (RAL 7021) dashtop & console with gloss black trim pieces
- Volvo 4" screen
- Space for electronics (12" or 16")
- Hard-top in polyester with built-in electric sunroof
- Glass windscreen with 2 fitted electric wipers
- Anti-reflection covering under windscreen in grained polyester
- 4 Cup holders

INTERIOR

- 3 gloss Alpi grey walnut woodwork
- Brown oak laminated floors
- Direct and indirect lighting LED

GALLEY

Headroom: 1,95m / 6'5"

- Double stainless steel sink, with mixer
- Ceramic hob
- White corian type worktop
- 218 l Fridge Freezer
- Covered stowage drawer
- Bin
- Units with white
- 4 Storage cupboards
- 1 Hull window with built-in opening porthole
- 2 220 V Sockets
- Leather covered handrails

SALOON (2-cabin layout only)

Headroom: 1,99m / 6'6"

- 4 person sofa, upholstery Crevin Club 07 fabric (standard)
- Wooden table, grey walnut - Stainless steel foot
- Position intended for television (24" max)
- 4 Storage cupboards
- 2 Storage lockers (under the seats)
- 2 Light wells
- 1 Hull window with built-in opening porthole
- 1 220 V socket
- Direct and indirect lighting

GUEST CABIN (3-cabin layout only)

Headroom: 1,99m / 6'6"

- 2 Bunk beds (0,52 x 1,97m / 1'8" x 6'6")
- 2 Reading lights
- 1 Bed head with drawer
- 1 Hanging locker
- 1 Hull window with built-in opening porthole
- 1 220 V socket
- Direct and indirect lighting

VIP CABIN (FORWARD)

Headroom: 1,94m / 6'4"

- 1 double bed (1,57 x 1,92 m / 5'2" x 6'4") or 2 single beds (sliding system)
- Marine mattress
- 2 Reading lights
- 2 Shelving unit
- 2 Hanger closets
- 1 Cupboard with shelves
- 1 220 V socket
- 2 Panorama windows with opening ports and shutters
- Opening deck hatch with mosquito screen/blind
- Direct and indirect lighting

VIP HEAD COMPARTMENT (FORWARD)

Headroom: 1,95m / 6'5"

- Basin with mixer tap
- Mirror
- 2 Storage cupboards
- 1 Opening porthole
- Shower separated by translucent door
- Quiet Flush electric toilet
- Slatted floor
- 2 220 V Sockets

OWNER'S CABIN (AFT)

Headroom: 1,93m / 6'4"

- Double berth (1,50 x 1,99m / 4'11" x 6'6")
- Marine mattress
- Padded headboard with indirect lighting
- 3 Storage lockers
- 1 Hanging locker
- Position intended for television (22")
- 2 220 V Sockets
- 2 Panorama windows with opening ports and shutters
- 1 Light well with shutter

OWNER'S HEAD COMPARTMENT (AFT)

Headroom: 1,98m / 6'6"

- Basin with mixer tap
- Mirror
- 3 Storage cupboards
- 1 Opening porthole
- Shower separated by translucent door
- Quiet Flush electric toilet
- Slatted floor
- 1 220 V socket

ENGINE

- Propulsion Z-drive or IPS
 - in the choice:
 - Volvo Diesel IPS 600 engine 2 x 440 HP
 - Volvo Diesel Z-drive engine 2 x D6 380 HP + Joystick
 - Throttle & controls
 - Neutral (Activation of neutral)
 - Station (Activation of the station)
 - Trim (Trim adjustment - only on Z-drive versions)
 - Docking joystick
 - Fuel filter with decanter
 - Seawater filter
 - Air intakes on the deck for engine compartment cooling
 - Engine room foam soundproofed
 - Fire extinguishing system activated from the steering station
 - Stainless steel fuel filler
 - 2 x 450 L / 119 US Gal Aluminum fuel tanks
- Steering system:
- Electric steering
 - 2 Bases or Pods with counter-rotating spirals
 - Electrical engine controls
 - Volvo IPS:
 - Trip computer
 - Cruise control
 - Single lever
 - Low speed
 - Volvo Z-Drive:
 - Trip computer
 - Cruise control
 - Tow mode
 - Single lever
 - Power trim assistant

ELECTRICITY

- 2 Engine batteries (12V - 115Ah) + 3 Service batteries (12V - 115Ah) + Electrical gauge
- 1 Extinguisher
- Power distributor
- Battery charger (12V - 40Ah)
- Interior sockets 220 V
- Shore power socket (220V - 32A)
- Spotlights and LED reading lights

PLUMBING

- 2 Roto moulded water tanks, capacity of 200 L / 53 US Gal each + Electrical gauge
- Stainless steel water filler
- Water pump for pressurising hot/cold water system
- 40 L / 11 US Gal water heater working off engine exchanger and 220 V
- 2 Bilge pumps:
 - 2 Electric bilge pumps (50L/minute)
 - 1 Manual bilge pump (30L/minute)
- 120 L / 32 US Gal rigid holding tank

SMART BOARD

"SEANAPPS" smart technology:

- For monitoring the boat's status and receiving alerts as well as maintenance advice via the associated mobile application.
- The type of information collected (GPS position, batteries, engine info, navigation data, etc.) varies according to the boat's configuration.



MISCELLANEOUS ITEMS

- Smoke detector

TRIM LEVEL & PACKS

CONFORT TRIM LEVEL

- 49 L Cockpit refrigerator
- Audio Pack Fusion: Fusion RA210 + 2 Speakers
- Garmin 12" Multifunction screen
- Port and starboard sliding windows

PACKS

ELECTRONIC PACK

- Induction charging station (mobile telephone)
- Ship control (web server)
- Broadband 4G Garmin radar
- Garmin 8416 Multifunction screen + Depth sounder (in place of the 12")
- Garmin autopilot
- 315i VHF + Garmin 800 AIS

PREMIUM FOREDECK PACK

- Forward sun deck: Retractable canopy
- Forward sun deck: cushion + Protective cover + 2 Cup holders (Upholstery depending on version)
- Forward sun deck: Courtesy lighting

SPORT CHIC PLUS PACK

- Glazed cockpit door + Aft electric bay window
- Wheel helm upgrade
- Carbon fiber anthracite cockpit padding
- Cockpit: LED strip
- Interior: White-laquer finished furniture

OPTIONS

INTERIOR LAYOUT / ONBOARD COMFORT

- Cockpit air conditioning (230V - 50Hz - 16 000 BTU)
- Saloon and cabin air conditioning (220V - 50Hz - 24 000 BTU)
- Forced air heating fuel
- Microwave oven (230V, 50Hz)
- Dishwasher for 6 sets
- Tableware kit - 6 people
- TV pre-wiring In the aft cabin (Owner's cabin): TV mount (up to 24"), power socket, aerial socket, Fusion Apollo RA670 2 speakers
- TV pre-wiring in saloon: TV mount (up to 28"), power socket, aerial socket, Fusion Apollo RA670 2 speakers
- TV pre-wiring in the forward cabin (VIP cabin): TV mount (up to 32"), power socket, aerial socket, Fusion Apollo RA670 2 speakers
- 8 Saloon upholstery:
 - Crevin Club 07 (standard)
 - Crevin Onix 50
 - Bora Bora 51
 - Marlin Auster
 - VERTICE River Rock
 - VERTICE Bianco
 - VERTICE Cava
 - VERTICE Robusta
- Venitian blinds (in galley, saloon/3rd cabin)
- Mosquito screens on portholes
- Starboard and portside window
- Sunroof glass + curtains
- Savage Abundance 31 carpet in saloon and cabins
- Carpet Berber Dune in saloon and cabins
- Slat mattresses (Owner's cabin & VIP cabin)
- Double berth in saloon (2-cabin layout)
- Garmin Surround View Camera System

WATER SYSTEM

- Pump for deck washing
- Shore fresh water supply

EXTERIOR OPTIONS

- Complete mooring kit
- Integrated hydraulic gangway
- Immersible Irodeck hydraulic bathing platform (maximum load 350 kg/771 lbs) and integrated tender supports
- Tender launching system (winch and rollers)
- Exterior upholstery:
 - Marlin Auster (standard)
 - Dolce Vita
- Exterior Sunworker black windscreen curtains
- Kenyon electric grill (Bathing platform)
- Cockpit ice maker
- TV pre-wiring in the cockpit: TV pre-fitting with electrical support (up to a TV size of 40"), power socket and aerial socket, Fusion Apollo RA670 (upgrade to RA210 in Confort trim), 2 speakers
- Aft cockpit cover basic
- Aft cockpit cover upgrade
- Black Sunworker sunshade for the cockpit
- Zaf Factor Luxe Cream cockpit carpet
- Protective covers, outside upholsteries
- Hull covering

ELECTRICAL SYSTEM

- 12V / 220V inverter (700 VA)
- 7 kVA Generator (220V / 50Hz)
- Battery isolation switch remote control
- Underwater lights
- Deck searchlight
- Aft lighting in the Hard-Top

ENGINE

- Bow thruster
- Zipwake automatic trim system