



GENERAL SPECIFICATIONS

• L.O.A	10,77m	35'4"
• Hull length	9,96m	32'8"
• L.W.L.	9,50m	31'2"
• Beam	3,57m	11'9"
• Deep draft (Cast iron)	2,00m	6'7"
• Deep ballast weight	1 580kg	3,482 lbs
• Shallow draft (Cast iron)	1,50m	4'11"
• Shallow ballast weight	1 860kg	4,099 lbs
• Performance draft (Hydraulic retractable keel)	1,25 - 2,550m	4'1" - 8'4"
• Performance ballast weight	1 506kg	3,319 lbs
• Air draft (all masts), with aerial	15,57m	51'1"
• Light displacement	5 470kg	12,046 lbs
• Fuel capacity (standard)	130L	34 US Gal
• Fresh water capacity:		
- standard	231L	61 US Gal
- Option	130L	34 US Gal
• Engine power		
- standard	21 HP	21 HP
- Option	30 HP	30 HP
- Electric engine	Cruise 6.0 FP	Cruise 6.0 FP

ARCHITECTS / DESIGNERS

- Naval Architect: Marc Lombard
- Outside & interior design: Nauta Design

EC CERTIFICATION

- Category A - 6 people
- Category B - 8 people
- Category C - 10 people

STANDARD SAILS DIMENSIONS

• Classic mainsail (standard)	31,40m ²	338 sq ft
• Furling mainsail (Option)	26,20m ²	282 sq ft
• Self-tacking jib (standard)	17,10m ²	184 sq ft
• Furling genoa (106 %)	23,30m ²	251 sq ft
• Code 0	50,40m ²	542 sq ft
• Asymmetric spinnaker	80,00m ²	861 sq ft
• Classical mast:		
- I	12,82m	42'1"
- J	3,65m	12'
- P	12,66m	41'6"
- E	4,15m	13'7"
• Roller furling mast:		
- I	12,79m	42'
- J	3,65m	12'
- P	12,56m	41'2"
- E	4,50m	14'9"

PERFORMANCE SAILS (Requires standard classical mast)

• Square top mainsail	35,30m ²	380 sq ft
• Genoa (on Flatdeck furler)	27m ²	290 sq ft

seawapps

CONNECT YOUR BOAT FREE YOUR MIND

STANDARD EQUIPMENT

CONSTRUCTION

- Design in accordance with European Directive requirements and according to CE certification
- Monolithic hull design in polyester
- Monolithic structural inner moulding bonded to the hull
- Fibreglass and balsa wood sandwich contact deck, with diamond pattern non-slip coating
- Hull-deck join screwed, bonded and trimmed with 1 bulwark
- Cast iron keel fixed with bolts and stainless steel backing plates
- 2 Underhung rudders with stainless steel stock
- White coloured hull - Grey metal hull graphics

DECK EQUIPMENT

RIGGING

- Standard mast $\frac{9}{10}$ anodized aluminum deck stepped, 2 aft-swept spreaders - Without backstay (Selden) - Without backstay
- Anodised aluminum boom
- Discontinuous stainless steel standing rigging
- Rigid boom vang with tackle
- Self-tacking jib rigging with on-deck furler
- Mainsail stay rope on the roof (with 2 chainplates)
- 1 Self-tacking jib track with traveller
- Complete running rigging: Mainsail halyard, Genoa halyard with cleat on mast, Boom topping lift with cleat on mast, Mainsheet, 1 Self-tacking jib sheet
- 8 Clutches

WINCHES

- 1 Self-tailing winch (H35.2 STA) to port, on the roof
- 1 Aluminum winch handle
- 1 Port side halyard bag, Cadet Grey
- 1 Winch handle box

SAILS (Sail technology)

- Classic Dacron C-breeze mainsail with Natural UV protection, cross cut, semi full batten
- Self-tacking jib Dacron C-breeze with UV protection Natural, horizontal cut

MOORING LINES - MOORING

- Self-draining chain locker - Clench bolt - Hatch cover
- Single stem roller
- 6 Aluminum mooring cleats - Stainless steel chafing plate

SAFETY ON DECK

- Stainless steel pulpit 2 sections
- 2 Stainless steel pushpits
- 1 Lifebuoy support bracket
- Double guard lines and stainless steel stanchions
- Welded ring on pushpit for flag
- Emergency ladder on pushpit

COCKPIT

- Self-draining cockpit
- 1 Cockpit locker under port side bench
- 2 Lockers in cockpit bottom
- Side helm's seats (aft helm seats in trim)
- 1 Liferaft locker to aft of cockpit (Usable dimensions: 800mm x 505mm x 370mm / 2'7" x 1'8" x 1'3")
- Iro-Deck slatted cockpit benches (1,56m x 0,50m / 5'1" x 1'8")
- Polyester drop-leaf cockpit table, Stainless steel handrail
- Tilling positon: Stainless steel steering wheels - 800mm diameter / 2'7" - Leather covered - Steering gear at the helm station - Steering line transmission system - Stainless steel handrail - 1 Cup holder
- Solid wood slatted helm seats
- 1 Steering compass to starboard of the companionway
- 2 Deck access points to tiller system
- 1 Emergency tiller
- Engine throttle and control panel on starboard
- 2 Hinged PMMA companionway doors - Sliding hatch made of PMMA
- 1 Fixed, telescopic stainless steel swimming ladder

SWIM PLATFORM / AFT TRANSOM (Escape Pack)

- Fully opening transom, convertible to bathing platform (2,35m x 0,70m / 7'9" x 2'4")
- Manual opening using hoist, assisted by 2 pull cylinders
- Iro-Deck slatted swim deck
- 1 Fixed, telescopic stainless steel swimming ladder

INTERIOR

- Sand oak alpi joinery
- Nordic Teak type laminated floorboards
- Beige padding upholstery: Saloon & Cabins
- Néo 05 fabric interior upholstery
- Mattresses in the cabins, HR35kg/m3 foam

Standard version: 2 cabins + 1 head

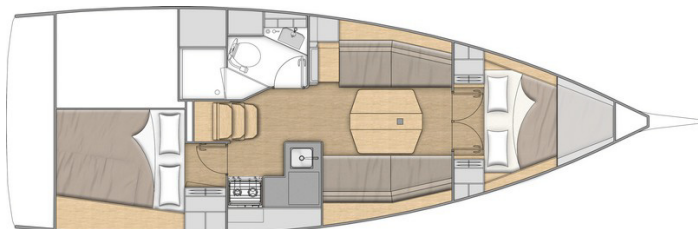

COMPANIONWAY

Headroom: 1,89m / 6'2"

- GRP saloon companionway coated with non-slip surface on the steps
- 2 Stainless steel handrails covered with anthracite leather

SALOON

Headroom: 1,90 - 1,85m / 6'3" - 6'1"

- 2 Lengthways saloon bench sets, can be used as a single berth: an extension cushion for the port side bench seat is stowed against the bulkhead under the chart table
- Saloon table with 2 drop-leaves and 2 central top-access storage spaces. For the retractable keel version, the dimensions of the table are larger to accommodate the keel raising system
- Storage under bench seats
- 2 LED ceiling lights
- 1 USB socket on the 12V electrical panel
- 2 Panoramic roof windows
- 2 Hull portholes with curtain
- 1 Flush deck hatch with fan, T44, blind and mosquito net

STARBOARD GALLEY

L-shaped galley - To starboard

Headroom: 1,85m / 6'1"

- Worktop in compact Clay with painted wooden fiddles + Compact sink cover with cutting board
- 1 1 rectangular stainless steel sink (320mm x 300mm / 1'1" x 1')
- 1 Mixer tap with hot/cold water under pressure
- 1 Gas cooker 2 burners - Stainless steel oven on gimbal - Stainless steel protection handrail
- Cool box 100 L / 26 US Gal top opening (Positive cold)
- Storage and lockers
- 1 Dual compartment slide-out bin (2 x 15L / 2 x 4 US Gal)
- 1 230 V socket
- 1 Opening porthole on coaming in the side window with mosquito net

PORT SIDE CHART TABLE

Headroom: 1,85m / 6'1"

- Chart table with folding tray against the starboard bulkhead with shelves fitted with fiddles in the upper part
- 12 V electrical panel nearby
- 1 Adjustable LED spotlight
- 1 230 V socket
- 1 Single USB socket
- 1 Fixed coaming window with pleated blind

OWNER'S CABIN

Headroom: 1,86m / 6'1"

- 1 Central double bed (2,02m x 1,60m - 0,55m / 6'8" x 5'3" - 1'10")
- 2 Hanging closets with 1 open shelf on top, open lockers along the hull
- 2 Adjustable LED spotlights in the headboard
- 1 dual USB port outlet on each side of the bed
- 1 230 V socket (to port)
- 1 Flush deck hatch with fan, T44, blind and mosquito net
- 2 Hull portholes with curtain
- Double door

STARBOARD AFT CABIN

Headroom: 1,80m / 5'11"

- 1 Double bed (2,00m x 1,60m x 1,30m / 6'7" x 5'3" x 4'3")
- 1 Hanging closet with 1 open shelf on the top
- 1 Bed access sideboard
- 2 Adjustable LED spotlights in the headboard
- 1 dual USB port
- 1 230 V socket
- 1 Opening porthole on the cockpit coaming + Mosquito screens
- 1 Opening porthole below cockpit seat with curtain + Mosquito screen

AFT PORT SIDE HEAD

Access through saloon

Headroom: 1,92m / 6'4"

- Shower with plexiglass door - Self-draining storage bin - 1 Mixer tap - White polyester shower base
- 1 Manual toilet
- 1 80 L / 21 US Gal rigid holding tank
- 1 Polyester basin - 1 Hot/cold water mixer tap
- 1 Cabinet
- 1 Mirror
- Toilet accessories
- 1 Opening porthole in coaming
- 2 LED ceiling lights
- 1 230 V socket (except for 3 cabins 1 head version)

3 cabins 1 head version (Option)

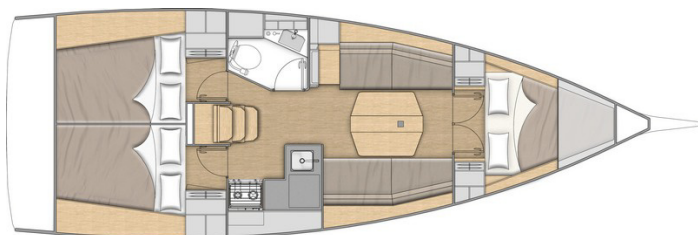

The head has a shower function mixer tap

2 SYMMETRICAL AFT CABINS

Headroom: 1,80m / 5'11"

- 1 Double bed (2,00m x 1,40m x 1,13m / 6'7" x 4'7" x 3'8")
- 1 Hanging closet with 1 open shelf on the top
- 1 Bed access sideboard
- 2 Adjustable LED spotlights in the headboard
- 1 dual USB port
- 1 230 V socket
- 1 Opening porthole on the cockpit coaming with curtain + Mosquito screen
- 1 Opening porthole below cockpit seat with curtain + Mosquito screen

ENGINE

- Engine Yanmar Diesel (Propeller shaft):
 - 21 HP (standard)
 - 29 HP (Option)
- Torqeedo electric engine (Incompatible with Offshore Pack)
 - Pod Torqeedo Cruise 6.0 FP TorqLink, Fixed 5 blades propeller
 - 1 Power 48-5000 W Lithium battery
 - 1 650 W charger
 - Control on starboard console
- Engine control - Control panel in cockpit (To starboard)
- Engine compartment: Soundproofing foam - Ventilation: 2 Air intakes and 1 powered air expulsion
- 1 Alternator (12V / 125Ah)
- 1 Rotomoulded diesel tank 130 L / *34 US Gal* (below aft starboard cabin berth) - Gauge on electrical panel - 1 Deck filler
- Filters: Seawater - Diesel - Water separator
- Stainless steel shaft line
- Fixed three blades propeller
- 1 Engine access through companionway (opening with 2 gas struts)
- 2 Access to side engine: Head & Aft cabin

ELECTRICITY

- 12V circuit
- 2 Pre-fittings for AGM service battery (100Ah)
- 1 Pre-fitting for AGM engine battery (50Ah)
- Battery charge display, Navicolor screen (3.5")
- 1 Power distributor
- 1 40 Amperes battery charger
- 12 V electrical panel (Fuses - Voltmeter - 1 Fuel gauge)
- 6 USB sockets
- Full 230 V system (6 Inside sockets, 1 Shore power socket)
- LED lighting: Overhead lights, Adjustable spotlight in cabins & at chart table + LED indirect lighting in saloon
- LED navigation lights: 1 Masthead light - 1 Engine navigation light - 1 Anchor light on masthead

PLUMBING

- 1 Rotomoulded freshwater tank 206 L / *54 US Gal*, under berth in forward cabin
- Electrical gauge on 12 V panel
- 1 Deck filler
- Pressurised electric water pump - Expansion tank - Inline filter
- 25 L / *7 US Gal* Electric water heater (engine use) below saloon starboard bench
- 1 80 L / *21 US Gal* rigid holding tank
- 1 Electric bilge pump - 1 Manual bilge pump
- 1 Electric shower drain pump

GAS

- Gas cylinder locker - starboard aft cockpit
- Regulator and safety tap
- Gas leak detector

SMART BOARD

"SEANAPPS" smart technology:

- For monitoring the boat's status and receiving alerts as well as maintenance advice via the associated mobile application.
- The type of information collected (GPS position, batteries, engine info, navigation data, etc.) varies according to the boat's configuration.

seanapps

CONNECT YOUR BOAT **FREE YOUR MIND**

MISCELLANEOUS ITEMS

- Smoke detector
- Cleaning kit: eco-friendly cleaning products kit

PACKS

ELECTRONICS PACKS: RAYMARINE

	COASTAL	OFFSHORE
<ul style="list-style-type: none"> • 1 i70s display, to starboard from the companionway • i70s Sensor (Log, Speedometer, Temperature) • Wind Sensor (Windvane, Anenometer) • Windex Windvane 	<ul style="list-style-type: none"> ■ ■ ■ ■ 	<ul style="list-style-type: none"> ■ ■ ■ ■
<ul style="list-style-type: none"> • Starboard helmstation: <ul style="list-style-type: none"> - 1 Steering console - 1 7" Axiom + multi-function touchscreen (GPS, Chart plotter, Card reader - Navionics®+ Blank cartography included) - <i>The i70s display moves to the port side</i> - 1 Console cover, Cadet Grey • P70s autopilot + control (to port) • Chart table: RAY73 VHF, AIS receiver function 		<ul style="list-style-type: none"> ■ ■ ■ ■ ■

RIGGING PACKS (Incompatible with First Line Pack)

	DOWNWIND	UPWIND	DOWNWIND + UPWIND
<ul style="list-style-type: none"> • 1 Starboard manual (H35.2 STA) rigging winch + Cadet Grey halyard bag • Polyester bowsprit with integrated anchoring gear and bobstay (for Code 0 and asymmetric spinnaker) • Asymmetrical spinnaker rigging / Code 0 (sheets, Blocks, Halyards) • Additional jammers (on the roof for the halyard or on the coaming for the Genoa sheet, depending on the pack) • Rigging run back to cockpit (except boom topping lift) • 2 Manual (H40.2 STA) genoa sheet winches + Aluminum "Speed Grip" winch handle + Winch handle box • Genoa sheet 3D adjustment rings on the roof (replacing the self-tacking jib track and the traveller) • Genoa sheet on furler, high resistance Dacron (to replace the standard self-tacking jib) 	<ul style="list-style-type: none"> ■ ■ ■ 1 Triple jammer, on starboard roof ■ ■ 	<ul style="list-style-type: none"> ■ ■ ■ 2 Double jammers, in coaming (1 to port, 1 To starboard) ■ ■ ■ ■ 	<ul style="list-style-type: none"> ■ ■ ■ 2 Double jammers, in coaming + 1 Single clutch, on the coachroof ■ ■ ■ ■

IN-MAST FURLER PACK

- The standard Dacron C-breeze self-tacking jib is retained.
- Anodised aluminium ⁹/₁₀th in-mast furler (Selden), 2 sets of spreader bars
 - Dacron C-breeze cross-cut mainsail

PERFORMANCE PACK

FIRST LINE ALU PACK (incompatible with the rigging packs)

- Requires standard classic mast and a trim level
- Boast supplied without sail - Performance sails optional
- Polyester bowsprit with integrated anchoring gear and bobstay (for Code 0 and asymmetric spinnaker)
 - Flatdeck genoa furler
 - Additional jammers: 1 Double jammer on coaming to port and starboard for mainsail sheet, genoa sheet, adjustment of Genoa sheet traveller (control line) + 1 Triple jammer on the roof for spinnaker halyard/code 0
 - Performance, Punch, Dyneema core running rigging (Halyards: Mainsail, Genoa, Code 0, Asymmetric spinnaker)
 - Genoa sheet 3D adjustment rings on the roof
 - Asymmetrical spinnaker rigging / Code 0 (sheets, Blocks, Halyards)
 - German system (Two-way mainsheet at the helm station)
 - 1 Starboard manual (H35.2 STA) rigging winch + Cadet Grey halyard bag
 - 2 Manual (H40.2 STA) genoa sheet winches + Aluminum "Speed Grip" winch handle + Winch handle box
 - Performance hull decoration (Red sticker)

ESCAPE PACK

- 1 000 W Electric windlass - Remote control
- Slatted Iro-Deck aft platform with (manual opening), 1 Retractable stainless steel swimming ladder
- "Luxe" polyester/wood cockpit table, Stainless steel handrail, 1 Waterproof USB socket for charging smartphone or using LED lighting (lighting not supplied), Central storage (15L / 4 US Gal), Cup holders
- Cockpit shower (hot/cold water)
- Side gate openings
- HIFI: Fusion RA210 stereo + interior loudspeakers + Waterproof loudspeakers

OPTIONS

HULL - DECK - COCKPIT

- Pearl grey gel-coat
- Iro-Deck slatted cockpit floor
- "Luxe" polyester cockpit table (Requires the pack Escape: replacing the polyester/wood "Luxe" table)
- Cover for "Luxe" cockpit table (Cadet Grey)
- Steering wheels covers (Cadet Grey)
- "Luxe" coachroof sprayhood (Cadet Grey)
- "Luxe" bimini (Cadet Grey)
- Cockpit seats Dolce 51
- 12 V tunnel bow thruster (Side Power) + Pre-fitting for batteries (50Ah - 12V)
- 2 Mooring cleats on transom
- 3 folding blades propeller
- Mooring kit:
 - Delta 16 kg/32 lbs anchor (galvanized steel)
 - Chain (Diameter: 10mm / $\frac{3}{8}$ " - Length: 28m / 92')
 - Line (Diameter: 18mm / $\frac{11}{16}$ " - Length: 40m / 131')
 - 6 Fenders - M (Diameter: 200mm / 8" - Length: 635mm / 2'1")
 - 4 Moorings lines (Diameter: 16mm / $\frac{5}{8}$ " - Length: 12m / 39'4")
- Electric windlass (1 000 W) - Remote control
- Windlass control in cockpit with chain counter
- Outboard engine bracket
- Shore fresh water supply
- Stand + support plates on the hull (option required for grounding the retractable keel version)

NAVIGATION ELECTRONICS: RAYMARINE

- 1 9" Axiom+ screen on starboard console in lieu of 7"
- S100 Wireless autopilot remote control
- 700 AIS

RIGGING - SAILS

- Performance sail pack (Requires the pack First Line Alu): High resistance Dacron square-topped mainsail, 4 battens, Natural UV protection, cross cut + Genoa sheet on Flatdeck furler, high resistance Dacron, Natural UV protection, cross cut
- Code 0 on furler for mast with in-mast furling or standard mast, Lamine 15 Optic 2 (Light grey) - implies pack Downwind or First Line pack
- Natural colour Lazy bag + Lazy-jacks
- Self-tacking jib rigging (track and traveller) - implies pack Upwind or Upwind & Downwind pack

WINCHES

- 1 Port electric primary winch (H35.2 STAEH), in lieu of standard

INTERIOR EQUIPMENT

LAYOUT VERSIONS

- 2 cabins 1 head version
- 3 cabins 1 head version

AMBIANCE

- Brown oak laminated floors
- Interior upholstery according to colour chart
- Macadamia padding upholstery: Saloon & Cabins
- Companionway steps made from mixed wood on floor

ON BOARD COMFORT EQUIPMENT

- Saloon table upgrade: solid Alpi wood around the edge
- Sea water foot pump, in galley (with cool box drainage function)
- Additional fresh water tank (130L / 34 US Gal) below aft port side cabin bed
- 16 000 BTU air conditioning full boat (only for use via shore power supply) - Not compatible with 3 cabin version
- 8 000 BTU air conditioning saloon and front cabin (only for use via shore power supply)
- 8 000 BTU Autonomous air conditioning on Lithium battery in forward cabin and saloon, operating duration: 3 hours on battery, useful when at anchor + recharging and use of motor or shore power (12V - 230V) (Not compatible with heating, inverter, lithium battery options)
 - Included:
 - 1 Dedicated 12 V/230 V - 2 000 W inverter (this inverter does not allow the onboard comfort options)
 - 2 Lithium batteries (150Ah)
 - 1 60 Ah service battery charger (replacing the 40 Ah charger)
 - Navicolor 3.5" screen for displaying the battery charge level
- Forced air heating fuel
- 1 12V / 230V inverter - 2 000 W
- Quiet Flush seawater electric toilet
- Shore fresh water supply
- 1 150 Ah lithium battery replacing the 2 AGM100 Ah service batteries + Navicolor 3.5" screen for displaying the battery charge level.

The lithium batteries can be used in exactly the same way as the greater number of AGM batteries that they replace. This technology allows 100% of the battery capacity to be used compared with 75% for the AGM batteries. The engine battery is still AGM.
- Tableware kit - 6 people
- Fans in the saloon and cabins